

THE MARSHALL



ELEVATION B

Renderings and Plans are for marketing purposes only and are shown with additional options including siding. This information is deemed accurate, but cannot be guaranteed. Builder reserves the right to make changes at any time.

Contact Us



THE MARSHALL

OPTIONAL ELEVATIONS

Additional Elevations shown w/ shake, board and batten, PVC window trim, and/or architectural gable accents.



Elevation A



Elevation A



Elevation B



Elevation A

Renderings and Plans are for marketing purposes only and are shown with additional options including siding. This information is deemed accurate, but cannot be guaranteed. Builder reserves the right to make changes at any time.

THE MARSHALL

OPTIONAL ELEVATIONS

Additional Elevations shown w/ shake, board and batten, PVC window trim, and/or architectural gable accents.



Elevation B



Elevation C



Elevation C

Renderings and Plans are for marketing purposes only and are shown with additional options including siding. This information is deemed accurate, but cannot be guaranteed. Builder reserves the right to make changes at any time.

THE MARSHALL

2136 Finished Square Feet
1 Level/3BR/2.5BA
Spacious Great Room
Dining Room
2-Car Garage



Liberty Homes VA, Inc.
8249 Crown Colony
Parkway
Mechanicsville, VA 23116

Phone: (804) 730-7770
LibertyHomesVA.com

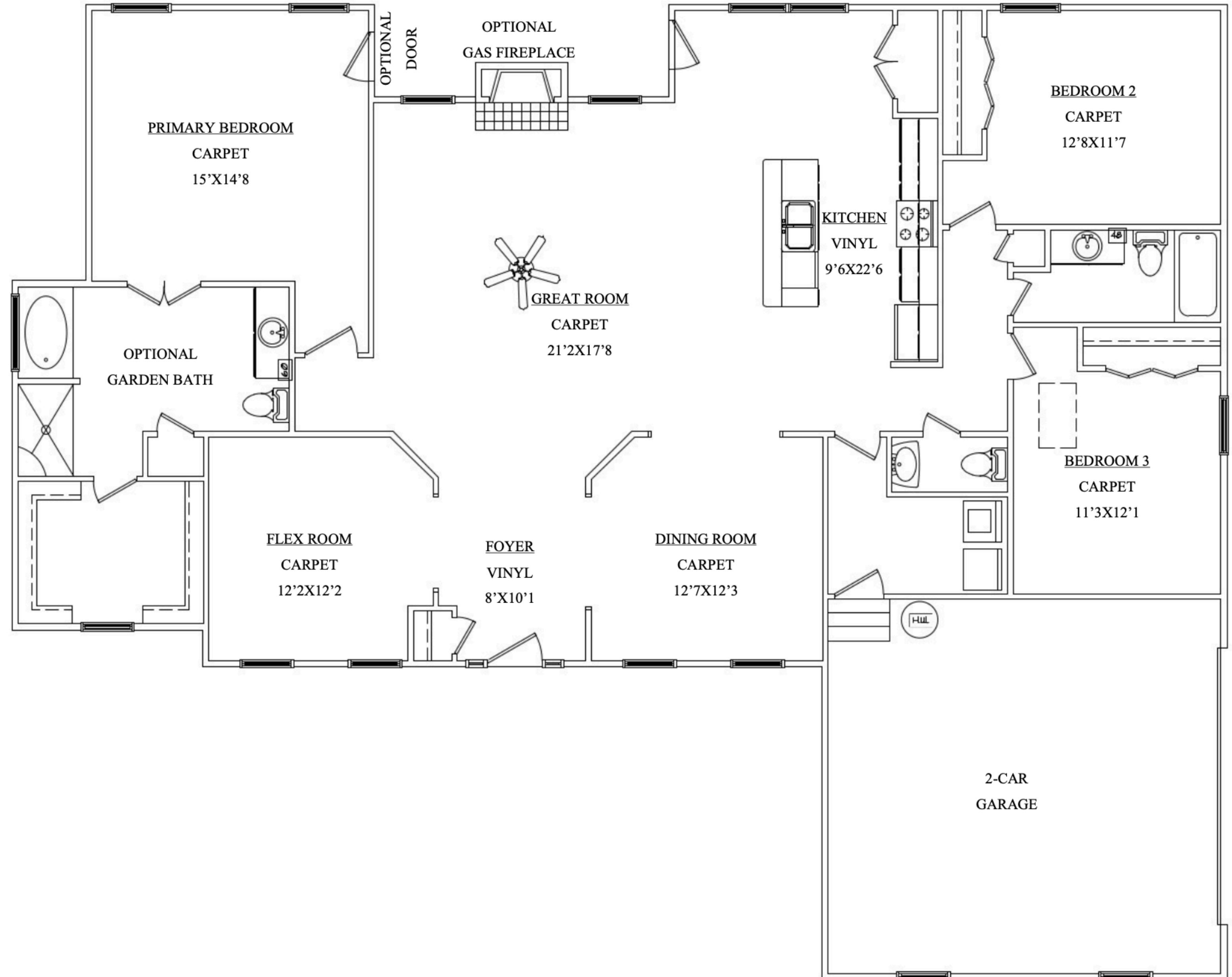

Renderings and Plans are for marketing purposes only and are shown with additional options including siding. This information is deemed accurate, but cannot be guaranteed. Builder reserves the right to make changes at any time.